

ENMARES

ENMARES Aviation Marine and Land Defense Incorporate

Tripod and Axle Jacks LOAD TEST TOOLS



Model Series: ENM-JLT and ENM-JTC

www.enmares.com

Tripod and Axle Jacks Load Test Tools

Parameter	Model No: JLT-D	Model No: JLC-SF	Model No: JLC-SM
Product Definition	Portable Load Test Tool for Tripod Jacks	Load Test Cabinet for Axle Jacks, Slings and Tiedowns	Load Test Cabinet for Axle Jacks, Slings and Tiedowns
Weight	164 kg	820 kg	845 kg
Nominal Dimensions	Height	1040 mm	1788 mm
	Length	378 mm	800 mm
	Width	378 mm	1140 mm
Load Test Capacity*	100.000 kgf	60.000 kgf	60.000 kgf
Test Unit Type	Digital Output Load Cell	Digital Output Load Cell	Digital Output Load Cell
Loading Direction	2-Way Permissible (Tension & Compression)	2-Way Permissible (Tension & Compression)	2-Way Permissible (Tension & Compression)
User Interface Indicator	Portable LED Segment / LCD Display (Optional)	Portable LED Segment / LCD Display (Optional)	Portable LED Segment / LCD Display (Optional)
Wheels for Mobility	N/A	-	■
Color	Customizable by the Customer	Customizable by the Customer	Customizable by the Customer

* Can be manufactured for different load capacities upon customer request. ■ Available [-] Not Available



JLT-D // Load Test Tool for Tripod Jacks

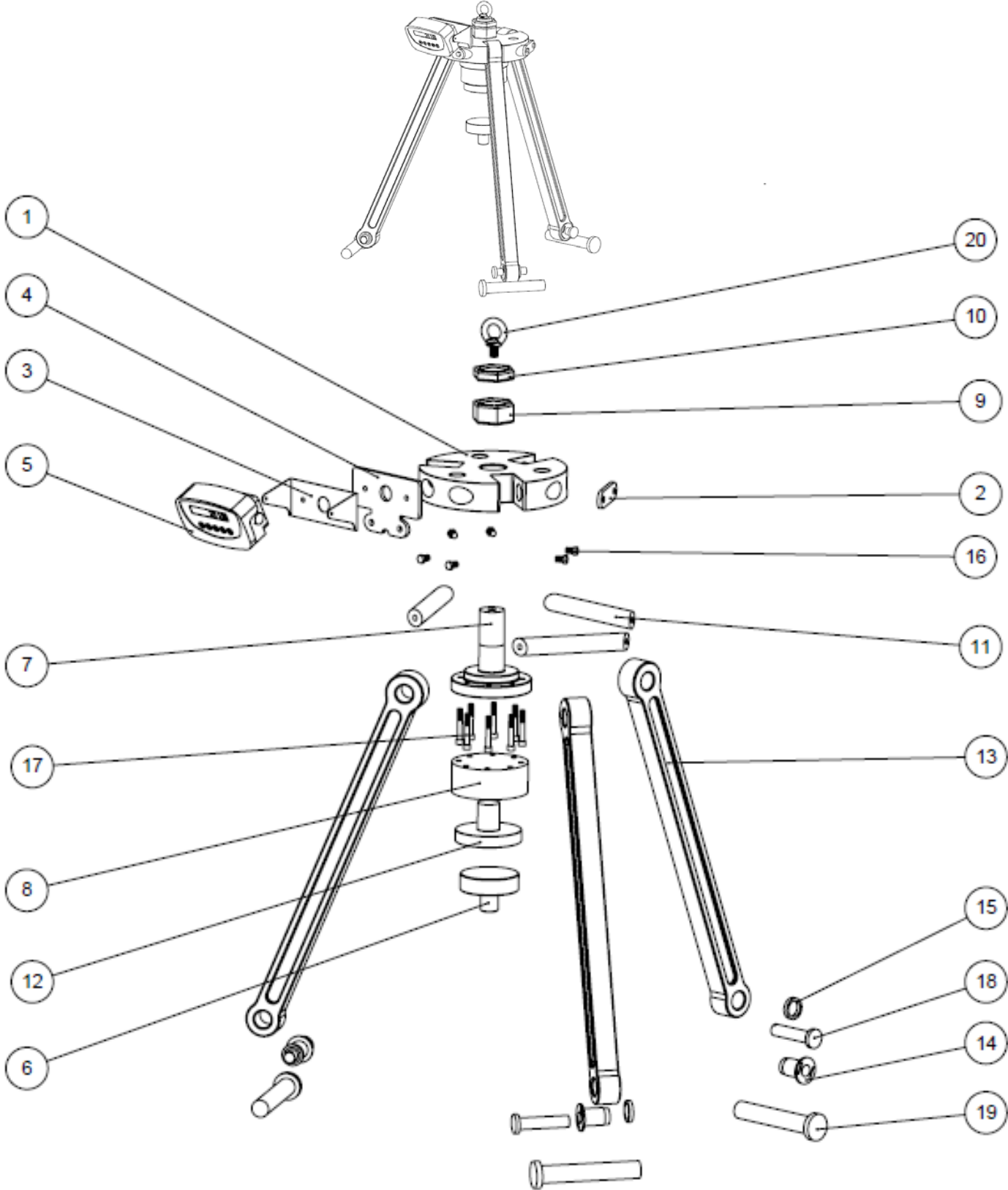

JLC-SX // Axle Jack Load Test Mode

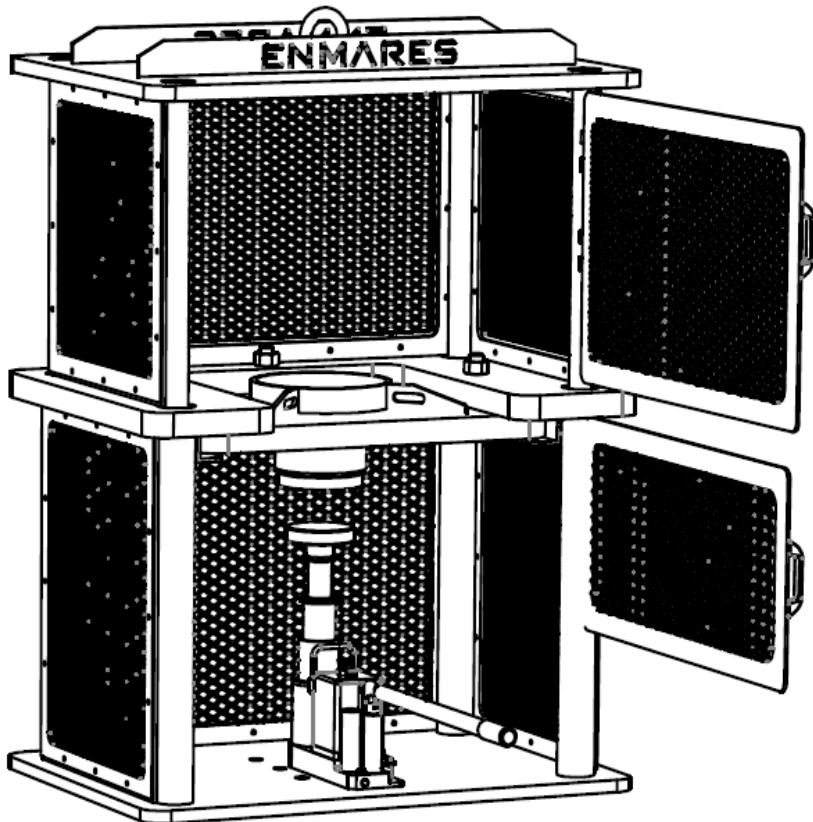
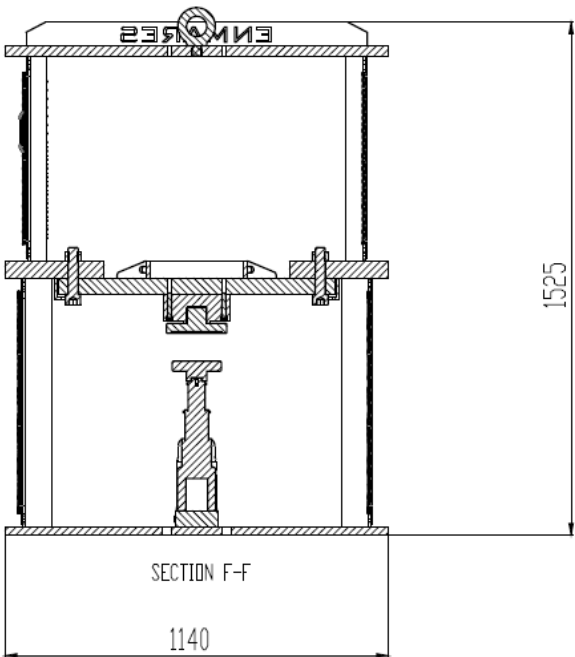
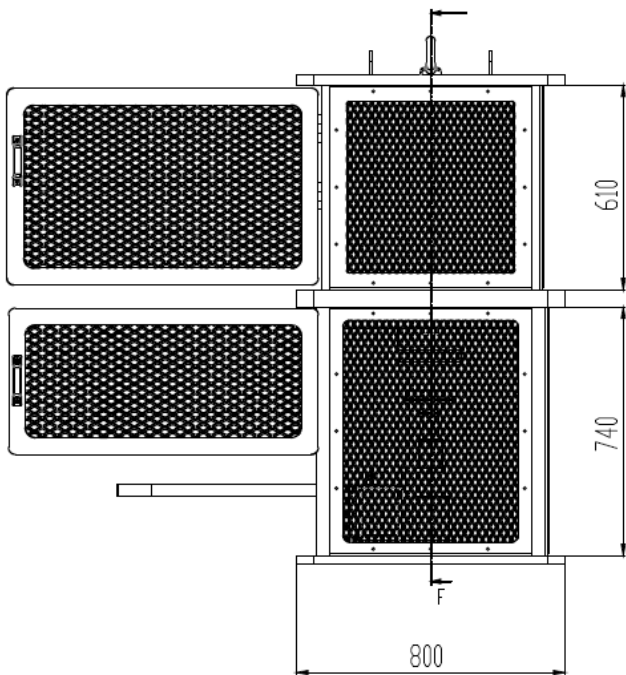

JLC-SX // Slings and Tiedowns Load Test Mode

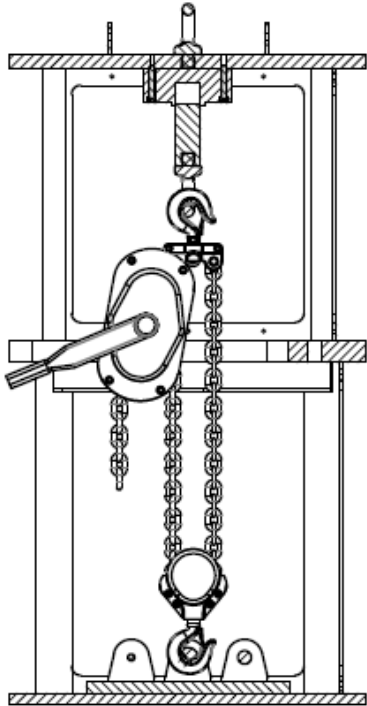
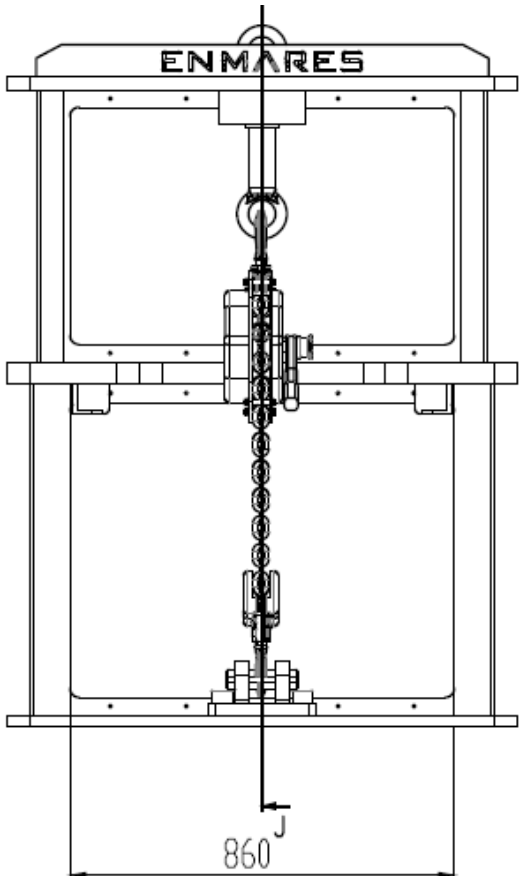

SECTION J-J

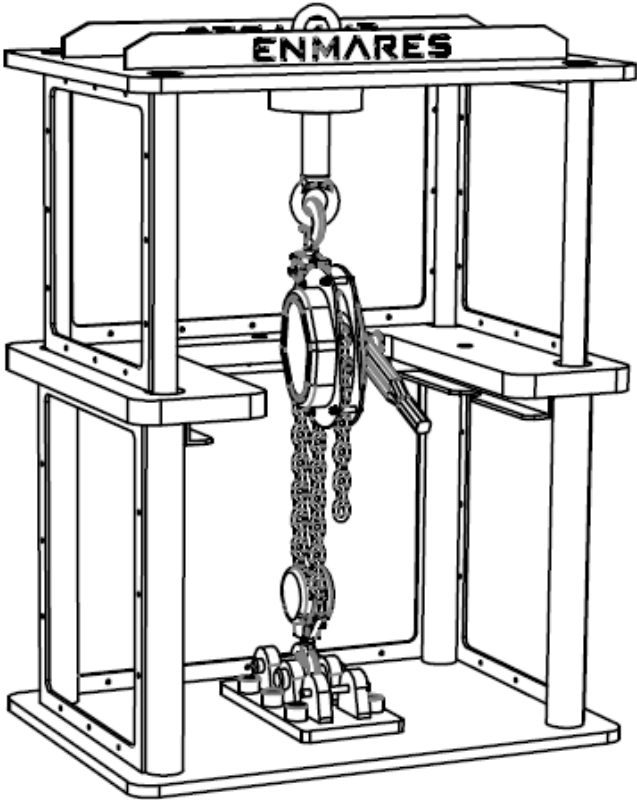

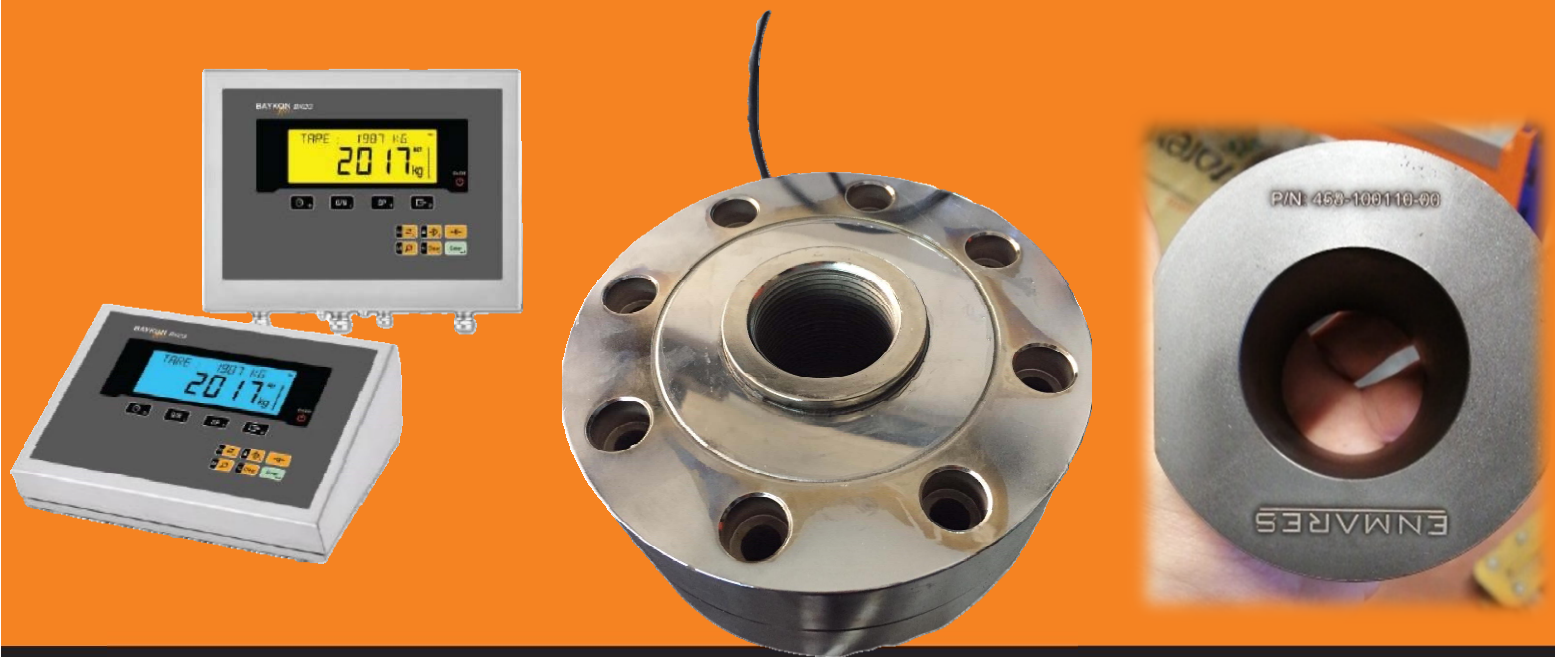

"As a NATO supplier engineering company, we design and manufacture a wide variety of aircraft maintenance, painting and assembly lines, special ground support equipment and mechanical systems for both civil and defense industries. Our complete scope of project implementation covers design, analysis, manufacturing, testing, documentation, shipment, commissioning and aftersales support. This becomes ENMARES' distinguishing power in many prestigious aviation and defense projects for years."

Rotary and Fixed Wing Aircraft Towing Vehicles
Helicopter Operation Equipment
Aircraft Assembly Line Solutions
Special Aircraft Docking Systems
Aircraft Painting Docking Systems
Aircraft Tire Inflation Cages
Aircraft Engine Components Clean Lines
On-the-vessel Helicopter Platforms
Special Electromechanic Weapon Systems
Composite Ballistic Armouring
Mobile Diesel Fire Extinguishing Pumps

ENMARES Aviation and Defense Company
NATO CAGE: TA642

Headquarters

E Kerim Gökay Cd. 286/154 34734 Erenköy / Kadıköy / İstanbul / Turkey Phone: +90 216 410 7177 Fax: +90 216 410 1641

sales@enmares.com
www.enmares.com